

\*\*Please refer to 0318-CH Package



Note :  
No dimensions on this drawing are to be scaled.  
All levels and dimensions on this drawing are to be checked on site. Any discrepancies on this drawing are to be reported to and verified with the architect.  
This drawing is to be read in conjunction with all other application documentation and information as issued.  
This is not a construction drawing, it is unsuitable for the purpose of construction and must on no account be used as such.  
This drawing is the copyright of Bucholz McEvoy Architects Ltd and may not be copied, altered, or reproduced in any form or passed to a third party without license or written consent.  
All extracts from ordnance survey tile ref: 3263-11, 3263-16  
Copyright: Ordnance Survey Ireland

- Occupancy:
- STUDIO
  - 1 BED
  - 2 BED
  - 3 BED

Back of house / layout and off licence area for retail element to be agreed post planning

- R1 Roof type 1 – Flat Roof  
R2 Roof type 2 – Extensive green roof system  
R3 Roof type 3 – Intensive green / blue roof system with terrace  
R4 Roof type 4 – Intensive green roof system  
R5 Roof type 5 – Intensive green roof system with PV Panels over  
R6 Roof type 6 – Roof Deck / Terrace  
R7 Roof type 7 – Roof Terrace
- Please refer to Roof Plan 0318-C-A2-07 for parapet levels and complete key to all elevation/section drawings

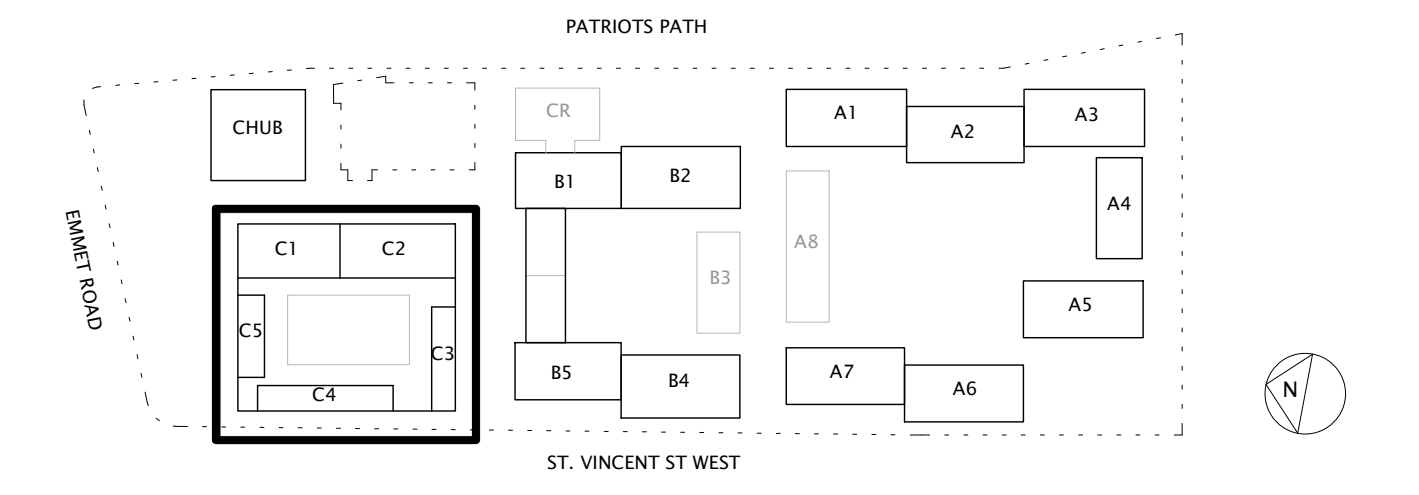

## PLANNING

revision	date	no.

drawing			
BLOCK C – COMMERCIAL MIXED USE – FIRST FLOOR PLAN			
drawing no.	scale	drawn	project no.
0318-C-A2-01	1 : 200 @ A1	SJ/MA	0318
	date	checked	revision
	SEPT 2022	KH	
project			
EMMET ROAD MIXED-USE DEVELOPMENT, DUBLIN 8			
client			
DUBLIN CITY COUNCIL			